

WARNING

ENSURE THAT THE FIREARM IS UNLOADED AND CLEAR BEFORE ATTEMPTING ANY WORK. IF YOU ARE UNSURE OF THE PROCEDURE THEN SEEK ASSISTANCE FROM A QUALIFIED GUNSMITH.

STEP 1

SEPARATE THE LOWER RECEIVER FROM THE UPPER RECEIVER. WHILE CONTROLLING THE HAMMER, PULL THE TRIGGER AND ALLOW THE HAMMER TO MOVE FORWARD. DO NOT ALLOW THE HAMMER TO STRIKE THE LOWER RECEIVER.

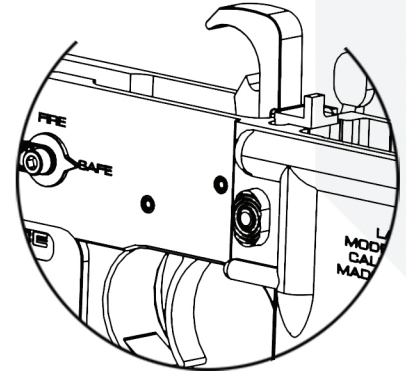

STEP 2

REMOVE THE PISTOL GRIP USING AN APPROPRIATE DRIVER. REMOVE THE SAFETY DETENT & SPRING.

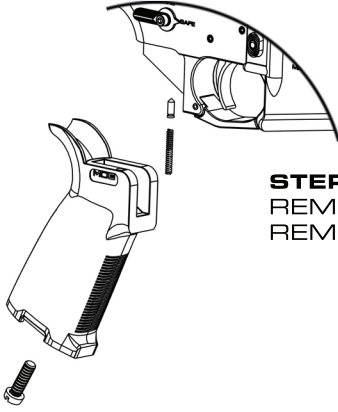

STEP 3

REMOVE THE SAFETY SELECTOR.

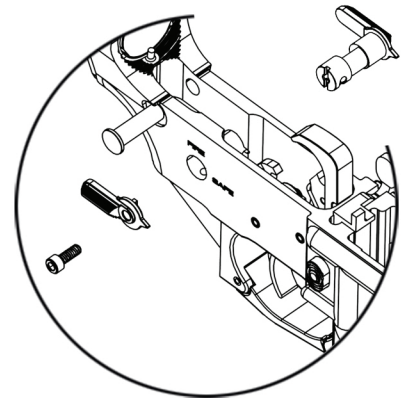

STEP 4

USING AN APPROPRIATE SIZED PUNCH REMOVE THE HAMMER PIN. TAKE CARE TO CONTROL THE HAMMER AS IT IS UNDER SPRING TENSION.

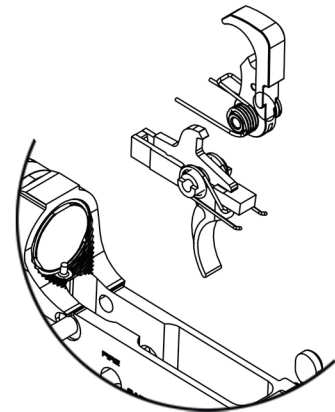
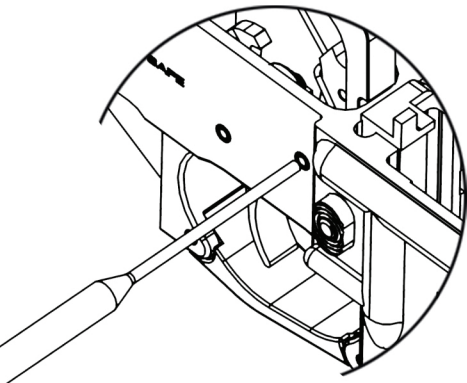

STEP 5

REMOVE THE TRIGGER PIN AND THE TRIGGER ASSEMBLY. THE DISCONNECTOR WILL SEPARATE FROM THE TRIGGER BODY.

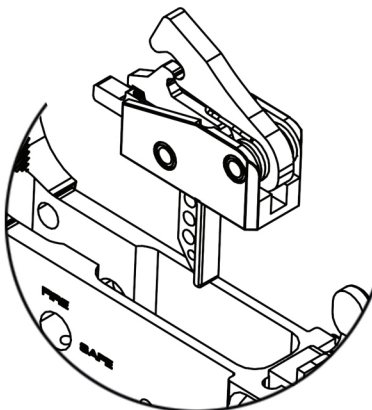

STEP 6

INSTALL THE E-CT1 TRIGGER INTO THE LOWER AND REPLACE THE SAFETY SELECTOR, DETENT, SPRING AND GRIP.

STEP 7

FIT THE SUPPLIED HAMMER AND TRIGGER PINS THROUGH THE LOWER RECEIVER. THE PINS WILL BE LOOSE AND REQUIRE FIXING BY TIGHTENING THE SET SCREWS IN THE TRIGGER ASSEMBLY. IF THE PINS ARE TIGHT THEN RELEASE THE SET SCREWS TO RELIEVE PRESSURE.

STEP 8

USING AN APPROPRIATE TOOL MOVE THE HAMMER SPRINGS ASIDE TO REVEAL THE SET SCREWS. ADJUST THE SCREWS USING A 5/64TH ALLEN WRENCH. TIGHTEN THE SCREWS UNTIL THE TRIGGER HOUSING APPLIES SUFFICIENT PRESSURE TO THE PINS AND THEY WILL NO LONGER MOVE.

STEP 9

REASSEMBLE THE FIREARM AND CONDUCT A TRIGGER FUNCTION CHECK.

